

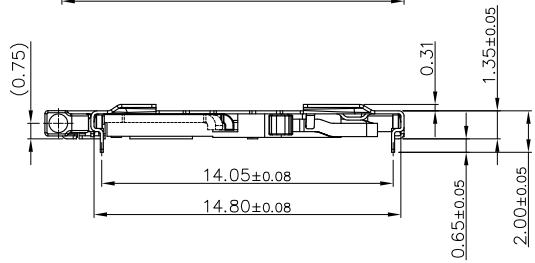

REV.	ECN. NO.	APPD.
A	ECN160906002	Fan Fang
B	ECN160914001	Fan Fang
C	ECN170120020	River

A  
B  
C  
D  
E

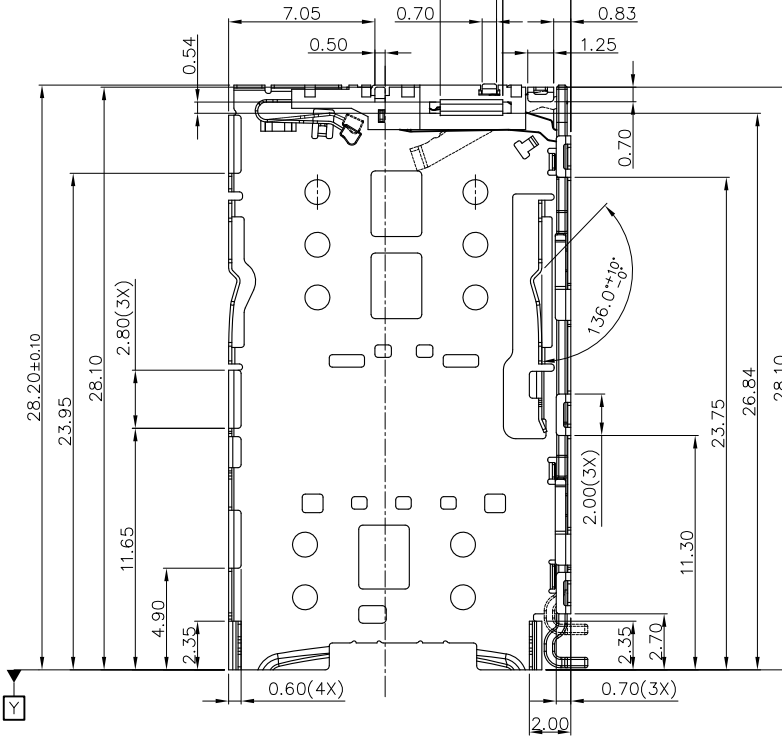
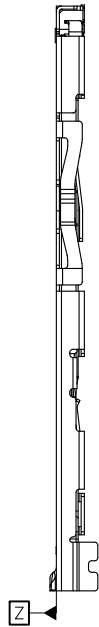
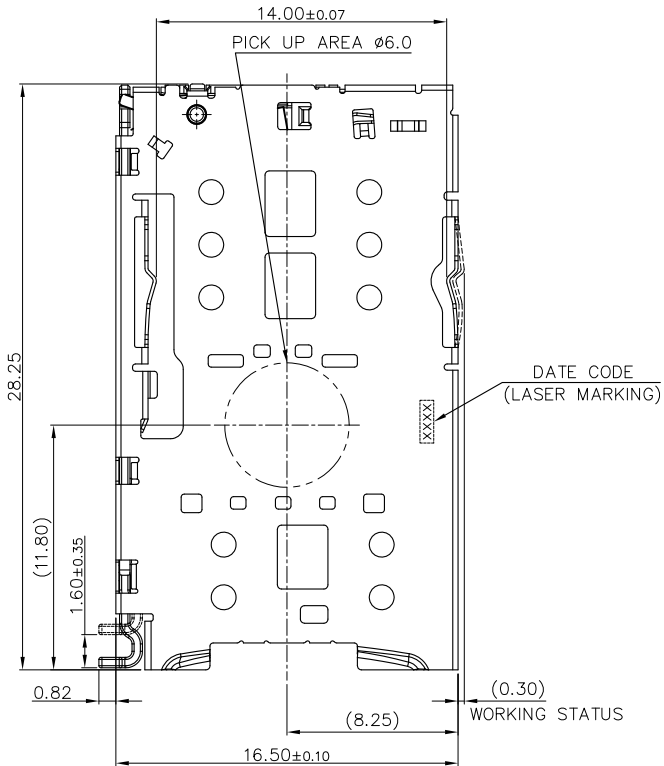

TIMING SEQUENCE

WHEN TRAY INSERT FIRST TIME, DETECEE SW. IS ACTIVATED

- NORMAL CLOSED SITUATION
- OPEN SITUATION WHEN TRAY INSERTED

SPECIFICATION

CONTACT RESISTANCE (DATA)	<100 mΩ	INITIAL
INSULATION RESISTANCE	≥1000MΩ	
HIGH VOLTAGE RESISTANCE	500V AC, 1 MINUTE	
OPERATING VOLTAGE (SELV)	10V DC	
PEAK CURRENT	MAX .0.5 A	
OPERATING TEMPERATURE	-20°C/+85°C	
STORAGE TEMPERATURE	-20°C/+85°C	
"RoHS" COMPLIANT		
MECHANICAL LIFETIME	MIN.2000 MATING CYCLE	
CONTACT FORCE	0.2N	
CO-PLANARITY	MAX.0.08 MM BEFORE REFLOW	
SOLDERPROFILE	MAX.0.10 MM AFTER REFLOW	
	MAX. 260°C, 10 SECONDS	

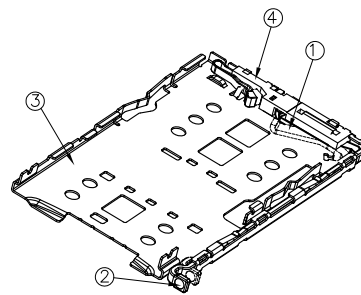

3D VIEW

4	SWITCH BLOCK	1	LCP	CONTACT AREA: GOLD FLASH UNDER PLATE: NICKEL OVER ALL SOLDER AREA: GOLD FLASH
	SWITCH PIN	1	SUS	UNDER PLATE: NICKEL OVER ALL
3	SHELL	1	SUS	CONTACT AREA: GOLD FLASH UNDER PLATE: NICKEL OVER ALL SOLDER AREA: GOLD FLASH UNDER PLATE: NICKEL OVER ALL
2	LEVER	1	SUS	N/A
1	CAM	1	SUS	N/A
ITEM	DESCRIPTION	Q'TY	MATERIAL	FINISH

UNITS: mm	GENERAL TOLERANCE	APPROVE: River	PART NO.: CS41DC1-12000-1H
DATE: 01/20'17	X. ±0.50 .X ±0.30	CHECKED: River	TITLE: CUSTOMER DRAWING FOR 1.35H PIN PUSH TRAY TYPE HOLDER OF 3 IN 2 CARD CONN.
SCALE: N/A	.XX ±0.20 .XXX ±0.10	DRAW: Suting	DRAWING NO.: 820-0000-0421
SHEET: 1/4	MATERIAL: N/A	Q'TY N/A	 Drapho ELECTRONICS TECHNOLOGY CO., LTD Highstar
REV.: C	FINISH: N/A		

1 2 3 4 5 6 7



REV.	ECN. NO.	APPD.

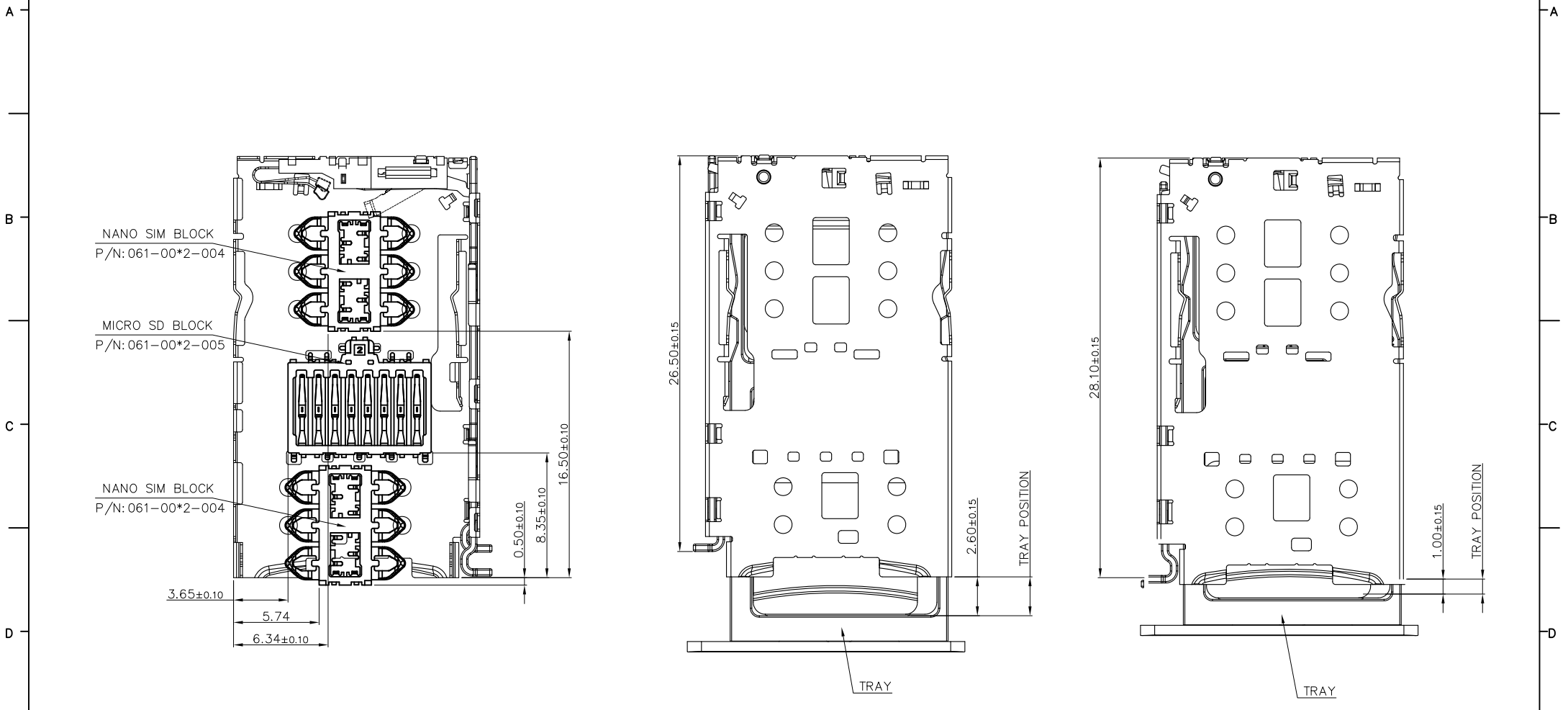

ASSEMBLY WITH SIM BLOCK  
(ON CUSTOMER SIDE)

EJECTED POSITION

MATED POSITION

UNITS: mm	GENERAL TOLERANCE		APPROVE: River	PART NO.: CS41DC1-12000-1H
DATE: 01/20'17	X. ±0.50 .X ±0.30	X* ±5* .X* ±3*	CHECKED: River	TITLE: CUSTOMER DRAWING FOR 1.35H PIN PUSH TRAY TYPE HOLDER OF 3 IN 2 CARD CONN.
SCALE: N/A	.XX ±0.20 .XXX ±0.10		DRAW: Suting	DRAWING NO.: 820-0000-0421
SHEET: 2/4	MATERIAL: N/A	Q'TY N/A	 Drapho ELECTRONICS TECHNOLOGY CO., LTD <span style="float: right;">Highstar</span>	
REV.: C	FINISH: N/A			



MICRO SD PIN DEFINITION

PIN	NAME
C1	DAT2
C2	CD/DAT3
C3	CMD
C4	VDD
C5	CLK
C6	VSS
C7	DAT0
C8	DAT1

NANO SIM PIN DEFINITION

PIN	NAME
S1,S11,S2,S12	VCC
S3,S13	RST
S4,S14,S5,S15	CLK
S6,S16,S7,S17	I/O
S8,S18	VPP
S9,S19,S10,S20	GND

HOLDER PIN DEFINITION

PIN	NAME
P1~P11	GROUND
P12	DETECT SWITCH

- SOLDERING PAD AREA
- KEEP OUT AREA (POSSIBLY TOUCH OF COMPONENTS ON PCB)
- CONNECTOR OUTLINE
- KEEP OUT AREA  
1.TOUCH AREA OF CONTACT TIPS,NO ELECTRICAL FUNCTION AND ONLY FOR MECHANICAL FUNCTION  
2.NO FIRST PCB-LAYER CIRCUITS IN THE AREA
- NONE SOLDER PAD AREA  
1.TOUCH AREA OF CONTACT TIPS,NO ELECTRICAL FUNCTION AND ONLY FOR MECHANICAL FUNCTION  
2.DON'T BRUSH TIN PASTED ON THE AREA DURING SMT PROCESS

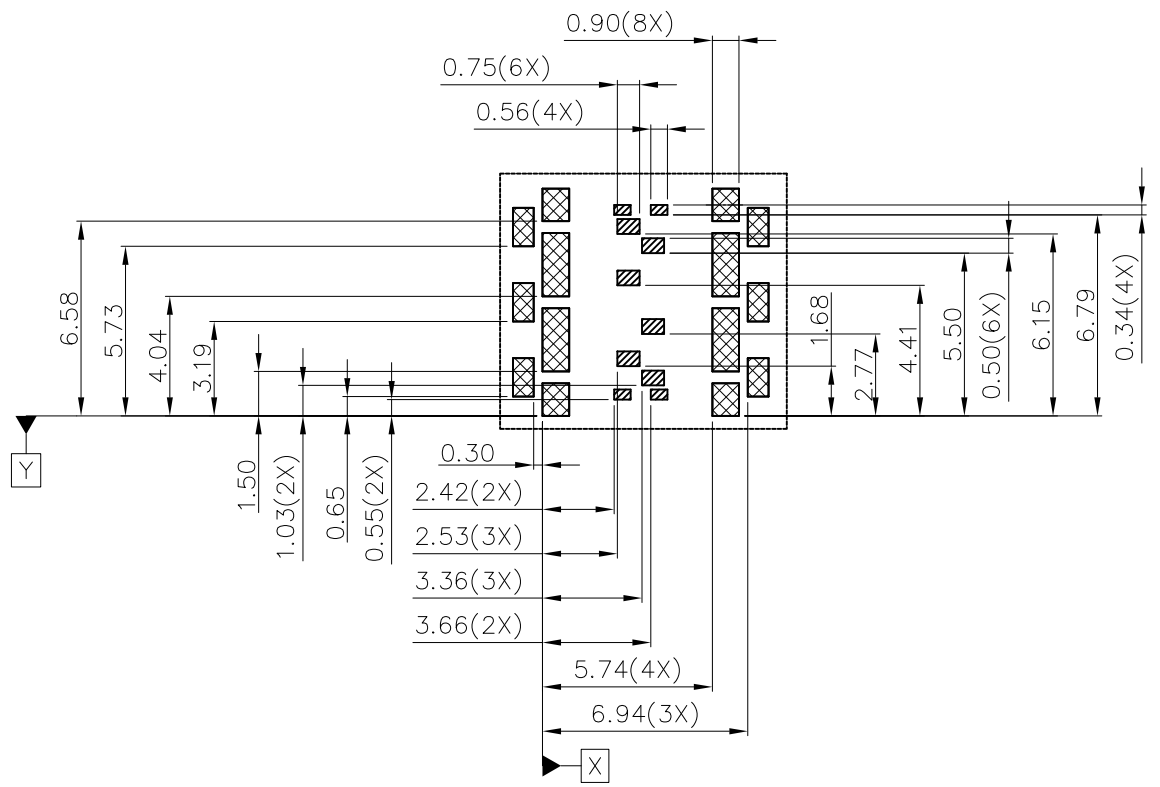

DETAIL A

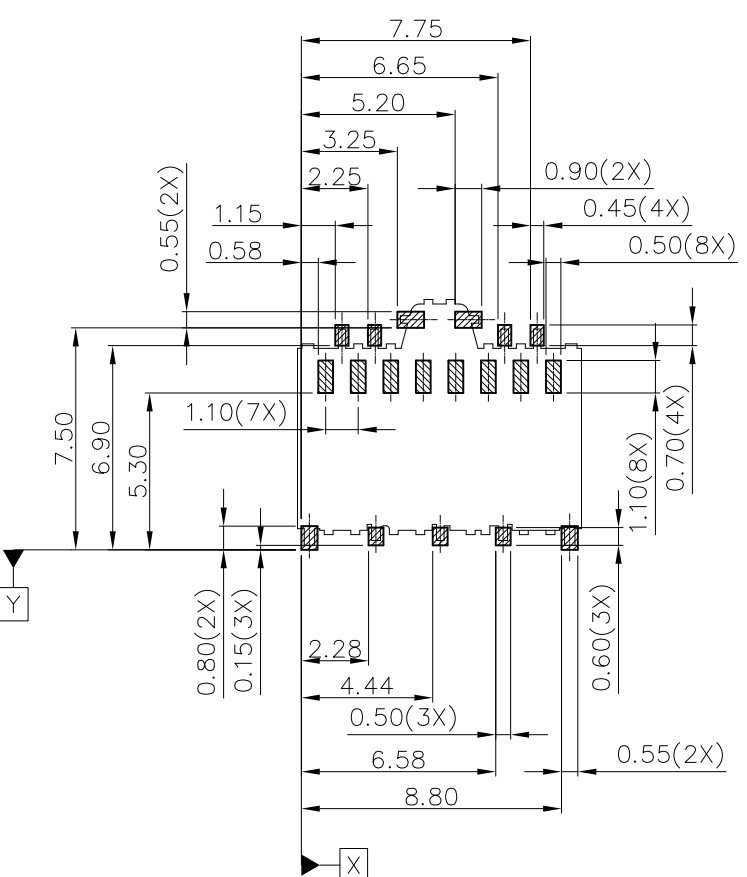

DETAIL B

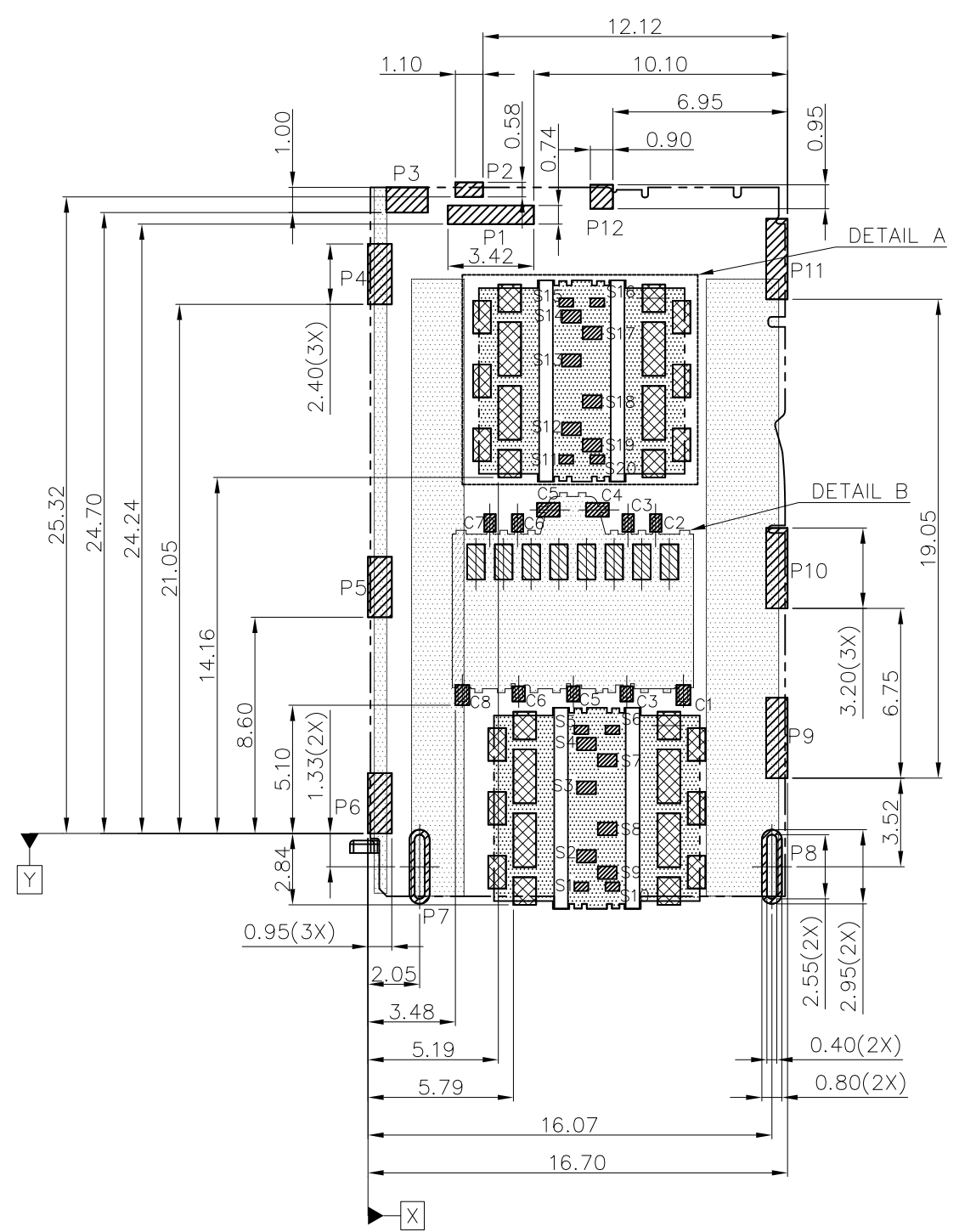

RECOMMEND PCB LAYOUT  
RECOMMEND TOLERANCE: ±0.05  
RECOMMEND STENCIL THICKNESS: ±0.10

UNITS: mm	GENERAL TOLERANCE	APPROVE: River	PART NO.: CS41DC1-12000-1H
DATE: 01/20'17	X. ±0.50 .X ±0.30 .XX ±0.20 .XXX ±0.10	CHECKED: River	TITLE: CUSTOMER DRAWING FOR 1.35SH PIN PUSH TRAY TYPE HOLDER OF 3 IN 2 CARD CONN.
SCALE: N/A		DRAW: Suting	DRAWING NO.: 820-0000-0421
SHEET: 3/4	MATERIAL: N/A	Q'TY N/A	Highstar Drapho ELECTRONICS TECHNOLOGY CO., LTD
REV.: C	FINISH: N/A		



REV.	ECN. NO.	APPD.

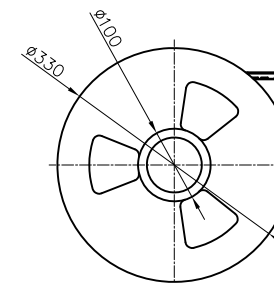
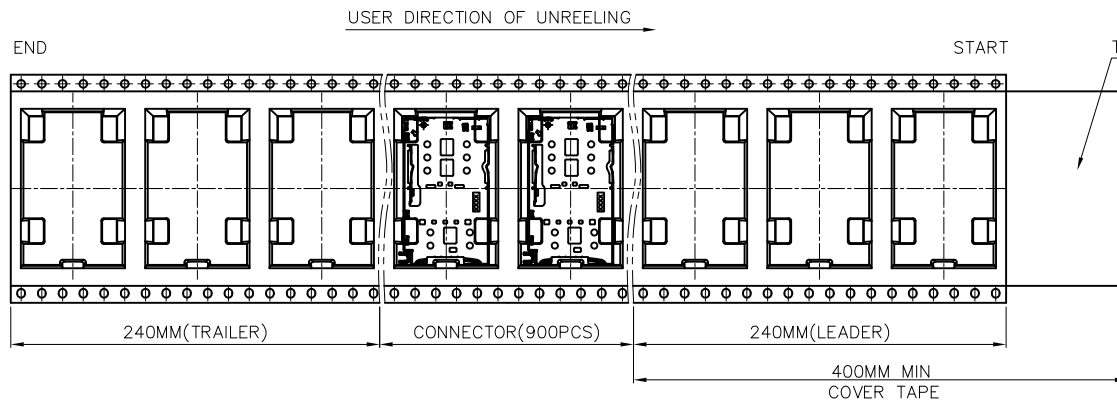
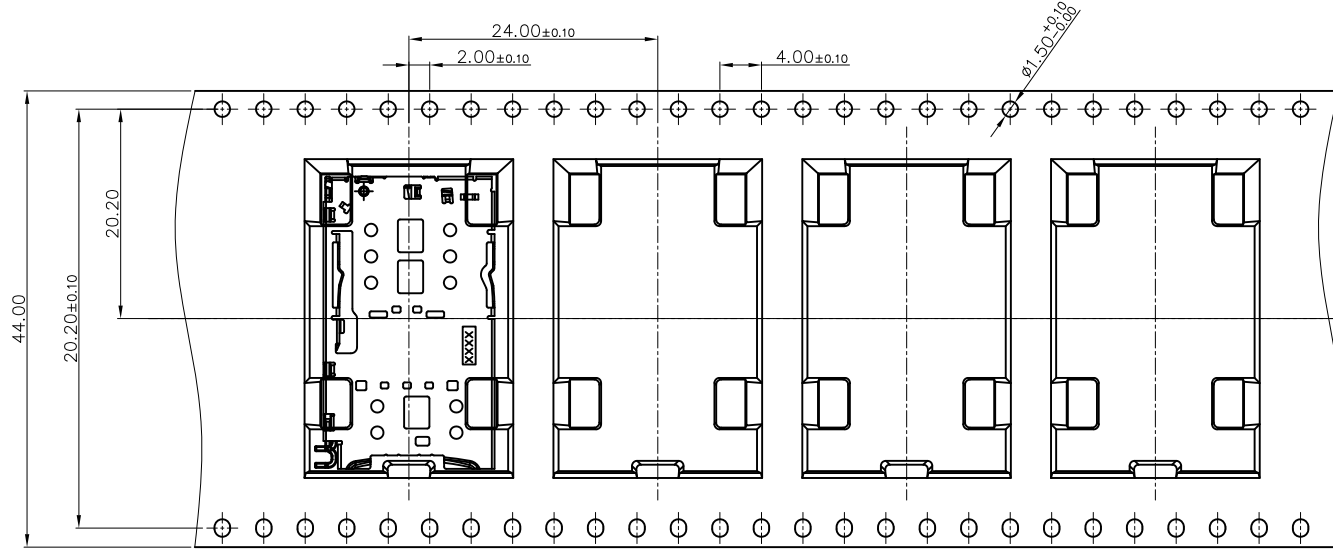

PACKAGE:  
Q'TY: 900PCS/REEL  
LEADER/TRAILER: SEE ABOVE  
13" REEL AND CARRIER TAPE ANTISTATIC

SCALE 1:1

UNITS: mm	GENERAL TOLERANCE		APPROVE: River	PART NO.: CS41DC1-12000-1H
DATE: 01/20'17	X. ±0.50 .X ±0.30	X.* ±5* .X* ±3*	CHECKED: River	TITLE: CUSTOMER DRAWING FOR 1.35H PIN PUSH TRAY TYPE HOLDER OF 3 IN 2 CARD CONN.
SCALE: N/A	.XX ±0.20 .XXX ±0.10		DRAW: Suting	DRAWING NO.: 820-0000-0421
SHEET: 4/4	MATERIAL: N/A	Q'TY N/A	 Highstar Drapho ELECTRONICS TECHNOLOGY CO., LTD	
REV.: C	FINISH: N/A	⊕		